

**NORTH HORSHAM PARISH COUNCIL
PLANNING, ENVIRONMENT AND TRANSPORT COMMITTEE
THURSDAY 19TH MARCH 2020 AT 7.30pm
AT ROFFEY MILLENNIUM HALL**

**CLERK'S REPORT TO BE READ IN CONJUNCTION WITH THE AGENDA
Numbers relate to those on the agenda.**

1. Public Forum

The Public Forum will last for a period of up to 15 minutes during which members of the public may put questions to the Council or draw attention to relevant matters relating to the business on the agenda. Each speaker is limited to 3 minutes. Business of the meeting will start immediately following the public forum or at 7.45pm whichever is the earlier.

3. Declaration of Interests

Members are advised to consider the agenda for the meeting and determine in advance if they may have a Personal, Prejudicial or a Disclosable Pecuniary Interest in any of the agenda items. If a Member decides they do have a declarable interest, they are reminded that the interest and the nature of the interest must be declared at the commencement of the consideration of the agenda item; or when the interest becomes apparent to them. Details of the interest will be included in the Minutes.

Where a Member has a Prejudicial Interest (which is not a Disclosable Pecuniary Interest), Members are reminded that they must now withdraw from the meeting chamber after making representations or asking questions.

If the interest is a Disclosable Pecuniary Interest, Members are reminded that they must take no part in the discussions of the item at all; or participate in any voting; and must withdraw from the meeting chamber; unless they have received a dispensation.

5. Chairman's Announcements

1. The Parish Council has received an annual update on Public Rights of Way matters from the Cabinet Member for Environment at West Sussex County Council. This has been circulated to all Parish Councillors.
2. The amended West Sussex County Council Permit Scheme (Road and Street Works) has been agreed and will come into effect on 1st April 2020.
3. ICCAN (the Independent Commission for Civil Aviation Noise) has recently launched a survey to ascertain how airports engage and consult with their local communities to understand where good practice has taken place. Individuals were invited to submit their comments by 13th March 2020.

4. Emergency work was undertaken to remove a fallen tree from Chennells Brook in the Cook Road open space area by Horsham District Council. The tree had been identified by the Environment Agency as causing a flood risk and needed to be removed as soon as possible. Remedial work to remove the stump and repair the ground in the area will be undertaken when the weather improves, and the ground hardens.
5. The results of Horsham District Council Planning Compliance review have been received and circulated to all Parish Councillors. No response is required at the present time.
6. The following Planning Application - DC/20/0470 - Land South of Newhouse Farm Old Crawley Road has been received for consultation.
This is an outline application for the erection of 473 dwellings, with new access provided off the Crawley Road, with associated areas of open space and landscaping. All matters reserved apart from access.

As this development type is classified as 001 -Largescale Major Dwellings we have applied to Horsham District Council for an extension to the period we have to provide comments. Due to public interest the Parish Council propose to have a separate meeting to consider this application.

7. Consultations

1. **Horsham Blueprint Business Neighbourhood Plan (Pre-submission) (Regulation 14)** – Consultation documents can be found at Horsham Library, Horsham District Council or by following this link www.horshamblueprint.org/draft-plan/. The consultation runs from 10th February 2020 to 24th March 2020.
 2. **Rusper Development Neighbourhood Plan (Regulation 16)** – Consultation documents can be found at Horsham Library, Horsham District Council or by following this link www.horsham.gov.uk/planningpolicy/planning-policy/currentconsultations The consultation runs from 24th February 2020 to 13th April 2020.
 3. **Installation of a School Safety Zone along Hawkesbourne Road for Pupils and Community of Littlehaven Infants School** – See Appendix A for plans sent for consideration. The scheme proposes to install a School Safety Zone along Hawkesbourne Road, replacing existing signage for flashing wig-wag signs as per the design shown in Annex 1.
Response required by 24th March 2020.
-

ANNEX 1

DO NOT SCALE

Notes:

- 1. - Sign Location 1 - Remove existing School Sign and post ready for installation of new powered signs.

070



Notes:

- 2. - Sign Location 2 - Remove existing School Sign and post ready for installation of new powered signs



Rev	Date	By	Description	CHK	APP
A	03/03/2020	MS	Design A - For Comments		

Drawing Status:
A - FOR COMMENTS

Project:
LTIP0162_Littlehaven_School_Sign_Removal

Site Address:
Littlehaven School, Hawkesbourne Rd
Horsham, RH12 4EH

PROJECT No	LTIP0162	DATE	03/03/2020
APPROVED		CHECKED	
DATE		DATE	

2 of 2
R1

West Sussex County Council

Northleigh, Tower Street,
Chichester, West Sussex,
PO19 1RQ



KEY -

- Existing School Signage
- Nearest Existing SSE LC

REPRODUCED FROM OR BASED UPON 2013 ORDNANCE SURVEY MATERIAL WITH PERMISSIONS OF THE CONTROLLER OF HMSO. CROWN COPYRIGHT RESERVED.

UNAUTHORISED REPRODUCTION INFRINGES CROWN COPYRIGHT AND MAY LEAD TO PROSECUTION OR CIVIL PROCEEDINGS.
WEST SUSSEX COUNTY COUNCIL LICENCE NO: 100023447

SSZ LOCATION 1

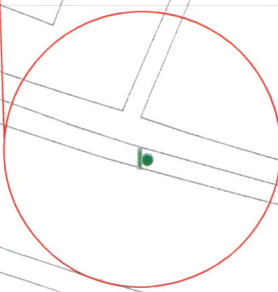

74.1m

SSZ LOCATION 2

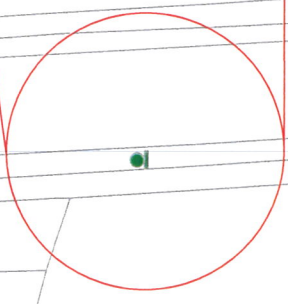

SSZ LOCATION 1



74.1m

SSZ LOCATION 2



DO NOT SCALE

Notes:
 1. - SSZ Location 1- Install new School Safety zone in the location of existing sign. NEW



Notes:
 2.- SSZ Location 2- Install new School Safety zone in the location of existing sign.



Rev	Date	By	Description	CHK	APP
A	03/03/2020	MS	Design A - For Comments		

Drawing Status:
A - FOR COMMENTS

Project:
LTIP0162_Littlehaven_School_Sign_New

Site Address:
Littlehaven School, Hawkesbourne Rd
Horsham, RH12 4EH

KEY -

- Location of new powered School Signage
- Nearest Existing SSE LC

SSZ Layout



REPRODUCED FROM OR BASED UPON 2013 ORDNANCE SURVEY MATERIAL WITH PERMISSIONS OF THE CONTROLLER OF HMISO. CROWN COPYRIGHT RESERVED.

UNAUTHORISED REPRODUCTION INFRINGES CROWN COPYRIGHT AND MAY LEAD TO PROSECUTION OR CIVIL PROCEEDINGS.

WEST SUSSEX COUNTY COUNCIL LICENCE NO: 100023447

West Sussex County Council

Northleigh, Tower Street,
Chichester, West Sussex,
PO19 1RQ

Not to Scale

PROJECT NO: LTIP0162

DATE: 03/03/2020

DRAWING NO: 1 of 2

APP: R1